



SWIFT. SILENT. SECURE.

M to S Adapter Plate Kit - Single Installation (White or Black) INSTRUCTIONS

INSTALLATION TOOLS:

- 3/4" Socket with ratchet
- 3/4" Wrench
- Marine grade sealant

HARDWARE INCLUDED:

A (4) M to S Seal Plug

B (1) M to S Shim

C (1) M to S Adapter Plate

INSTALLATION:

STEP 1: Properly remove and support your outboard engine according to the manufacturer's guidelines.

NOTE: Consult with your boat manufacturer for proper hardware.

STEP 2: Install the engine bolts through the back of the M to S adapter plate (C) and shim (B) so that the bolt head is flush with the transom side (FIG. 1 & 2).

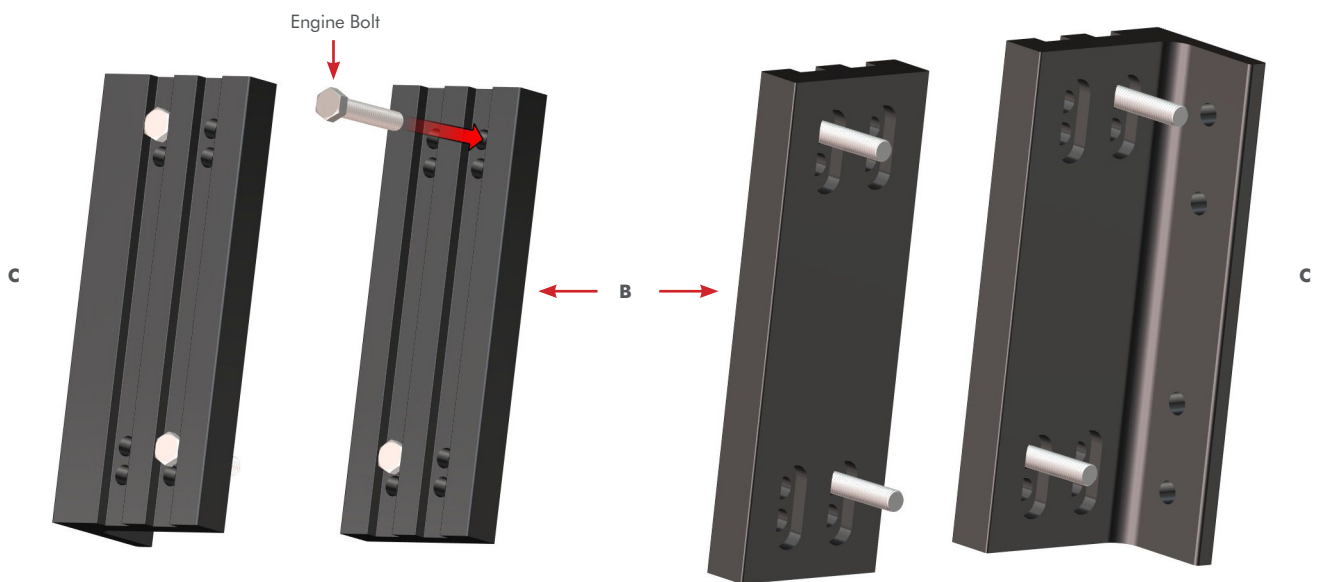
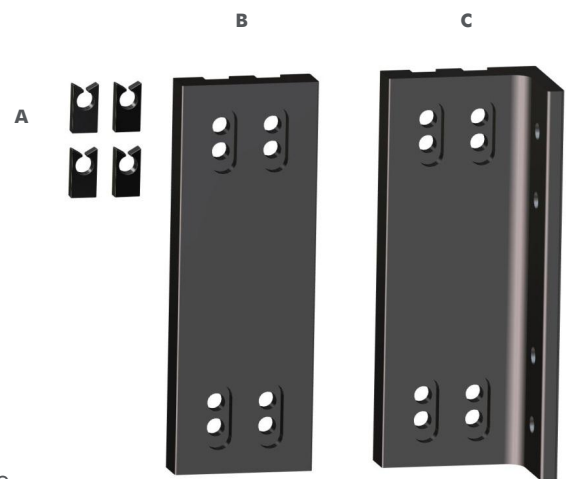

Figure 1
Transom side view

Figure 2
Engine side view



SWIFT. SILENT. SECURE.

M to S Adapter Plate Kit - Single Installation (White or Black) INSTRUCTIONS

STEP 3: Install the transom bolts through the holes directly below the engine bolts in the M to S adapter plate **(C)** and shim **(B)** as illustrated **(FIG. 3)**.

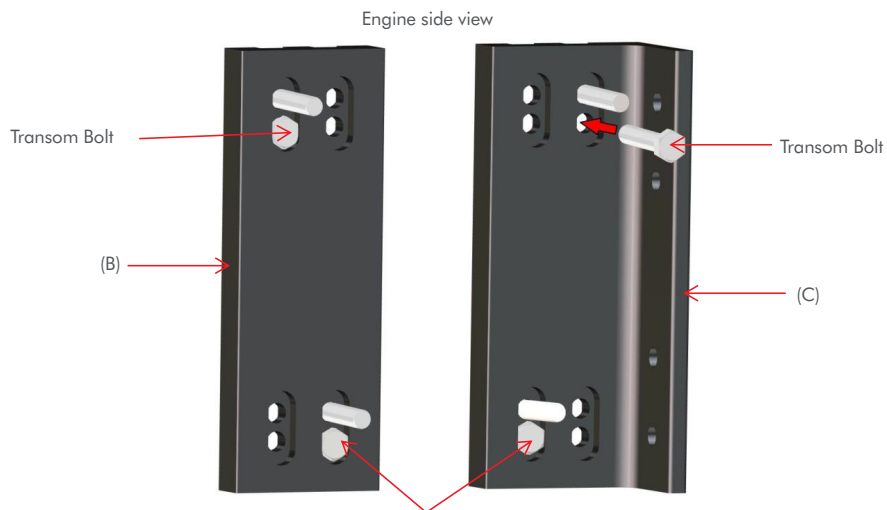

Figure 3

STEP 4: Install the M to S seal plugs **(A)** onto each transom bolt being used with the M to S Adapter Plate **(C)** and shim **(B)** as illustrated **(FIG. 4)**.

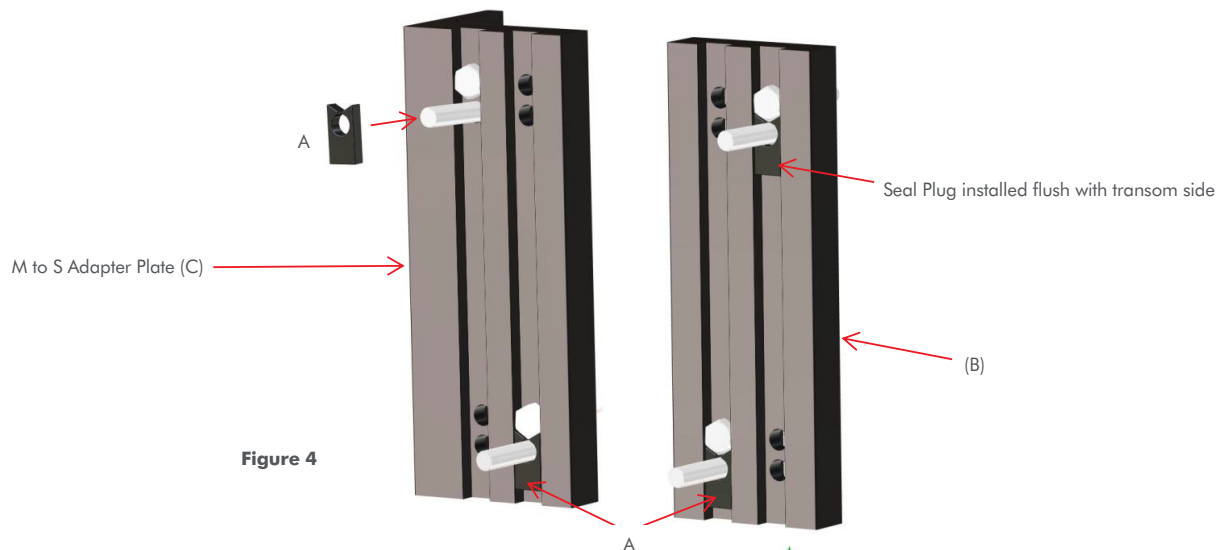

Figure 4



SWIFT. SILENT. SECURE.

M to S Adapter Plate Kit - Single Installation (White or Black) INSTRUCTIONS

STEP 5: Install the M to S adapter plate (**C**) and shim (**B**) onto the boat transom/jack plate and tighten to your boat manufacturer's torque specifications (**FIG. 5 or 6**).

NOTE: Put a below waterline grade sealant around each transom bolt hole if installing between outboard motor and transom.

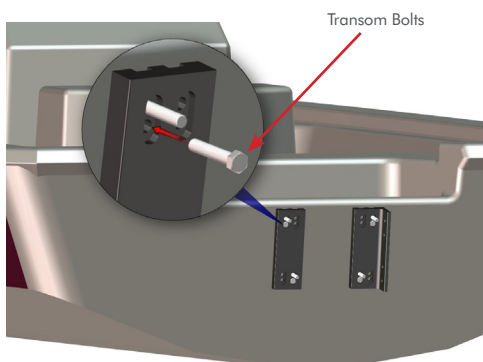

Figure 5

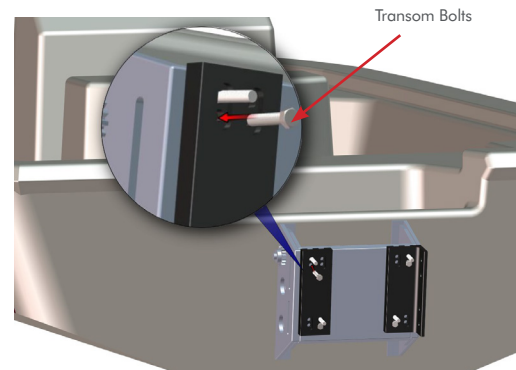

Figure 6

STEP 6: Remount your outboard engine using the hardware recommended by your boat manufacturer and torque to their specifications (**FIG. 7/FIG. 8**).

Mounting illustration
Use the second and fourth holes down from the top when mounting an S style adapter plate.

Figure 7

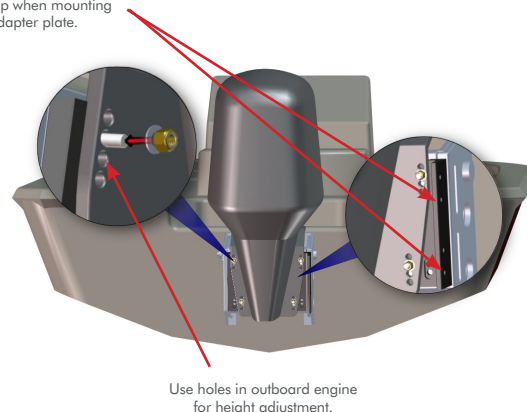
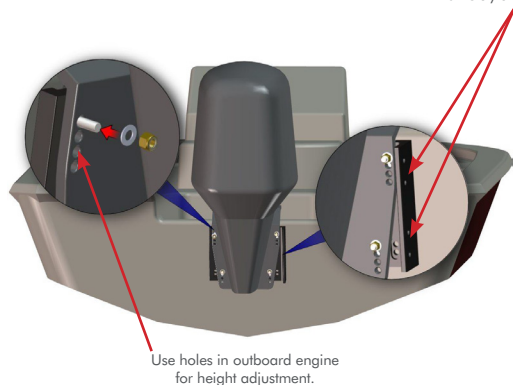

Figure 8



SWIFT. SILENT. SECURE.

M to S Adapter Plate Kit - Single Installation (White or Black) INSTRUCTIONS

CLEARANCE CHECKS

The M to S adapter plate (**C**) and shim (**B**) **MUST** be checked for clearance after installation. Failure to do so may result in loss of vessel control, which could lead to possible ejection from vessel causing property damage, personal injury, and / or death.

1. Confirm that the M to S adapter plate (**C**) and shim (**B**) do not cause the engine to interfere with steering cylinder(s), tie bars, steering hoses, outboard engine hoses or any combination of these parts in all steering positions.
2. If any interferences exists, you must take action and do one of the following:
 - a. Add a tilt limiter device to the outboard engine and ensure it is set to prevent the engine from reaching a position where interferences is possible.
 - b. Move the engine up to the next set of mounting bolt holes.

This product meets the requirements set forth in Mercury OEM Service Bulletin # 2013-09 Patent Pending

Need help? Contact our Technical Support Team at **1 + 813.689.9932 Option 2**



9010 Palm River Road, Tampa, Florida 33619 phone 813.689.9932 • fax 813.689.8883 • power-pole.com
©2018 all rights reserved. Power-Pole Shallow Water Anchor U.S. Patent No. 6,041,730